



WACACO

Wacaco Minipresso NS

Instructions for use

Dear Customer,

Thank you for having chosen our product and for your confidence in our company. We have devoted all our knowledge, our creativity and our care into the Minipresso so that it has been designed to meet and even exceed your expectations. We are confident Minipresso will serve you well for many years.

Minipresso gives you freedom to savour your favorite espresso on the go, at home or at work. Although it is compact, light and portable, it provides a high extraction quality, offering the ultimate espresso experience wherever you are and at any time of the day.

Share these moments with friends and enjoy every espresso!

WARNING!

Carefully read the following instructions before using your Minipresso machine. In this way you will avoid the risk of personal injury and damage to the appliance.

- Do not use the Minipresso for other than its intended use.
- After removing the packaging, make sure that the Minipresso is intact.
- The packaging elements (plastic bags, etc.) must not be left within reach of children as they are potential sources of danger.
- Do not allow the Minipresso to be used by children or uninstructed persons. Children must be kept under supervision to prevent them from playing with the Minipresso.
- Do not action the piston if the water tank and the outlet head are not in position.
- Never consume liquid directly from the Minipresso as contents may be hot.
- Do not put Minipresso on a gas or electric hot plate, in an oven, a microwave or a dishwasher.
- Only use clean water in the Minipresso. Do not use any other fluid.
- Never heat up the water directly in the water tank. Water must be heated by an external heating source such as a kettle and then poured into the water tank.
- Clean the Minipresso carefully and regularly.
- Do not use any accessories not recommended by Wacaco Company Limited, as this may cause injury.
- Do not use the Minipresso if it is showing any sign of breakdown

Instructions

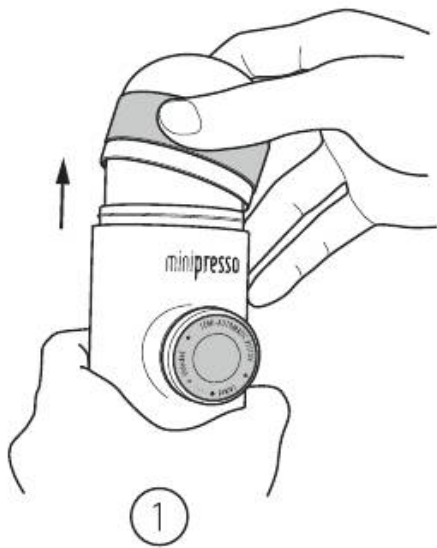

1. Unclip the cup.
2. Unscrew the outlet head.

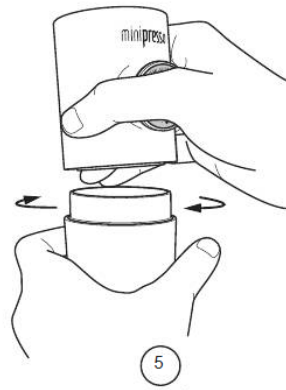

3. Place compatible capsule
4. Screw back tightly the outlet head in order to pierce the capsule.
5. Unscrew the water tank.

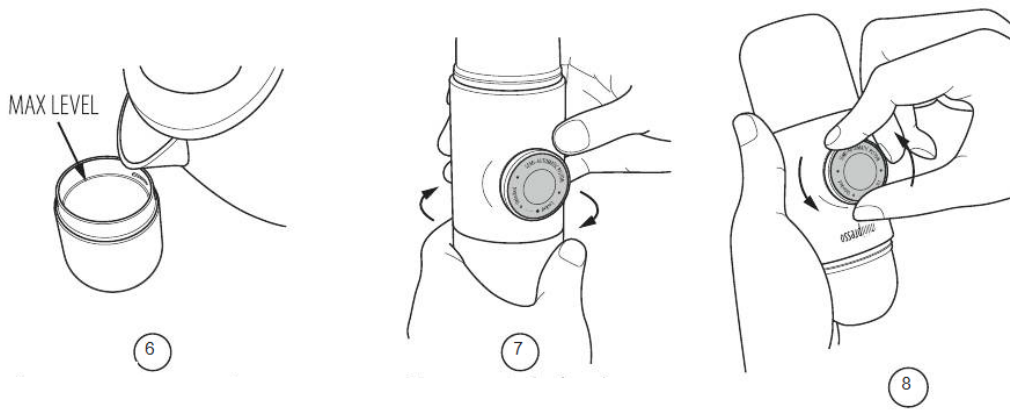

6. Add boiling water into the water tank. Place water tank on level & stable surface.

7. Screw tightly the main body onto the water tank. Avoid burning yourself.

8. Unlock the piston from its travel position by rotating it to the left.

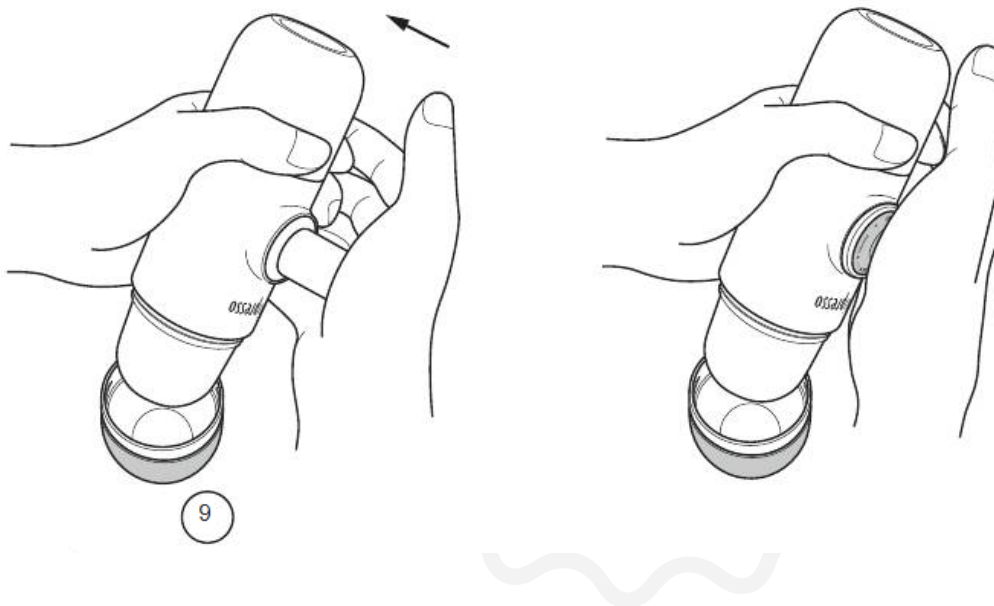

Cleaning

Clean the hatched areas under running water to remove all remain coffee. For all others areas, we highly recommend to only use a humid soft cloth. Let the parts dry separately.

WARNING!

Sharp cutter inside, only use the provided brush to clean the cutter and the surrounding area.

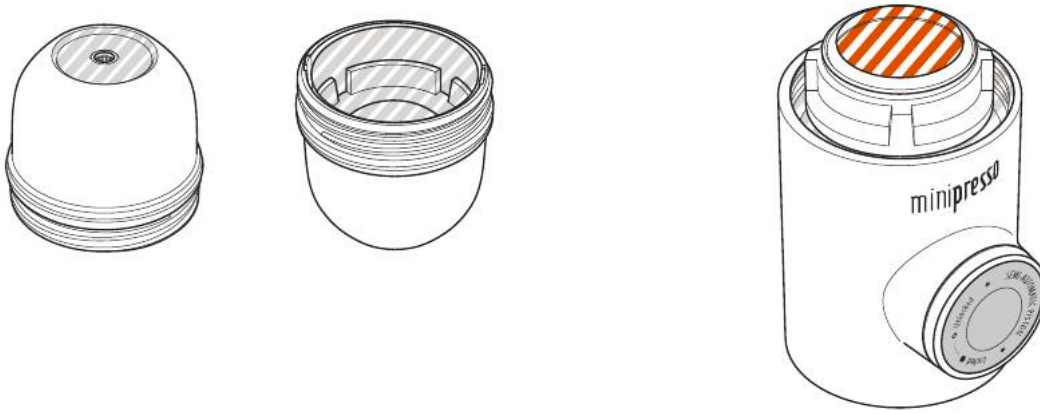

Do not put any Minipresso parts into dishwasher. Do not put water into the orange area.



Warranty and how to use the product

Products are covered by the standard statutory warranty period. This warranty is non-transferable and financial compensation in cash is not possible. The warranty does not apply to products that have been used in a manner other than that specified in these instructions for use.

The warranty also does not cover:

- Damage resulting from improper use, neglect of care, or any other use for purposes not listed in this manual.
- Damage to appearance, damage caused by corrosion or gradual wear and tear.

Any intervention or repair by unauthorized persons results in the voiding of the product warranty.

Seller and importer: NajTrade s.r.o., Húskova 31, 04023 Košice, IČO: 50590502.

