



# Flair Brew Scale

Instructions for use

## Product Components

- A. Coffee Scale
- B. Silicone Mat
- C. Power: Travel Mode
- D. TYPE-C Charging Port
- E. TYPE-C USB Cable
- + User Manual

To charge, make sure the power supply is turned ON. Do not use a quick charger.

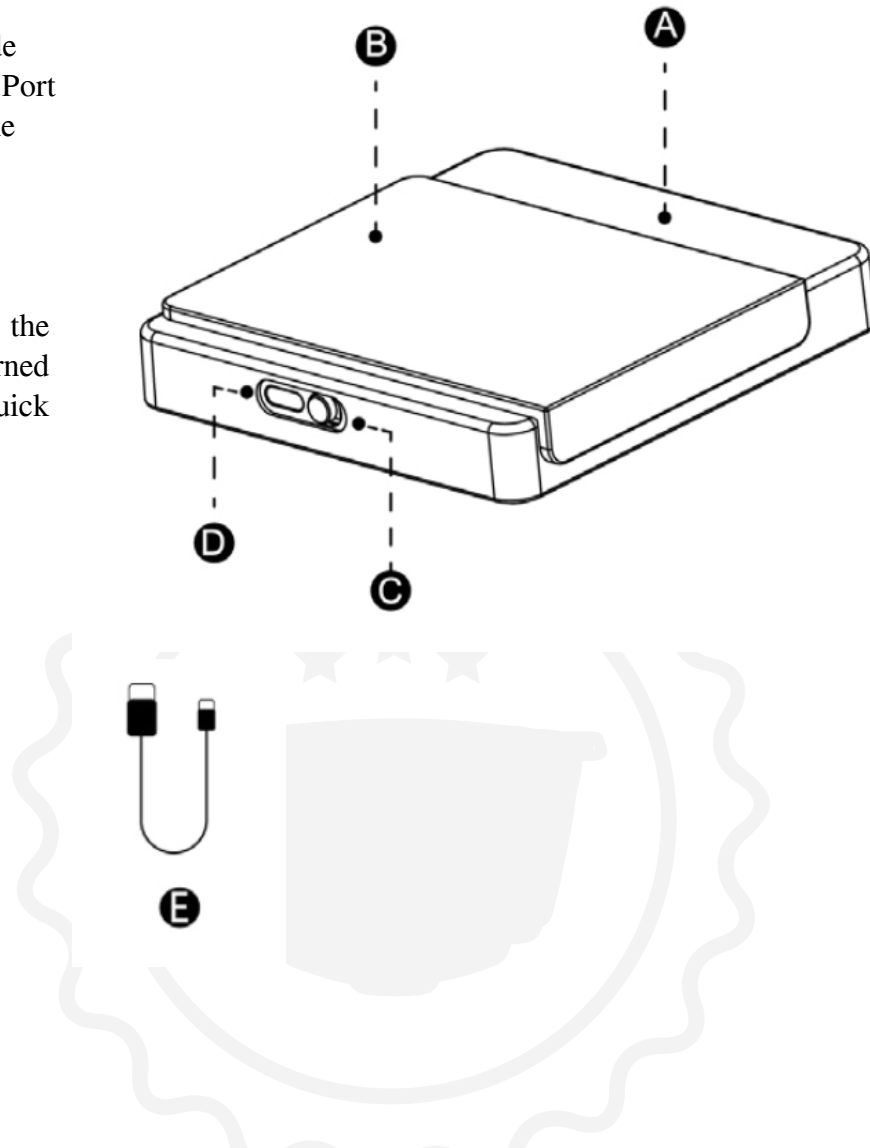

## CAUTION!

1. The scale is not waterproof. Do not wash. Keep the charging port dry.
2. The weighing capacity is 2,000g. Do not weigh items above this maximum limit.
3. To maintain battery life, use a charging source with an output of five (5) volts and one (1) amps.
4. Do not use the scale while it is plugged into an electrical outlet.
5. The scale must be used on a flat surface.
6. The scale is not drop-proof and may be damaged. Handle with care.

## Product Specs

- Item: Flair Brew Scale
- Max. Capacity: 2,000g
- Division: 0.1g
- Material: ABS/Silicone
- Product Size: 95 x 100 x 19mm
- Units: g / oz / ml
- Timer Range: 9 minutes 59 seconds
- Display: LED digit
- Battery: Built-in 800mAh rechargeable lithium battery
- Charging method: USB TYPE-C cable and 5V DC/1A adapter (self-provided)
- Charging display: Flashes when charging, stays on when fully charged.
- Low battery: Flashes when the battery is low. This continues until LO is displayed, and then the scale automatically turns off.

## Function Introduction

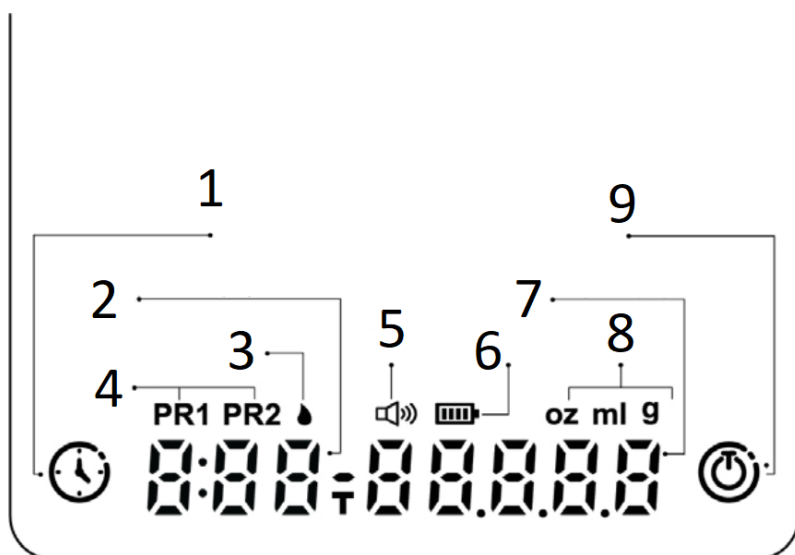

1. Press to start/stop timer  
Press and hold to reset timer  
Double press to change mode
2. Timer display area
3. Auto Timer
4. Modes
5. Sound
6. Battery indicator
7. Weight display area
8. Units
9. Press and hold to turn on/off  
Press to tare  
Double press to change unit

## Basic Getting Started

Sound ON/OFF: press and hold button 1 and 9 simultaneously for 1 sec.

To reset timer and weight, double tap button 1.

To tare weight, single tap 9 button.

To cycle through modes, double tap 1 button once then double tap a second time within 1 second to switch from PR1 to PR2.

To recharge, please ensure power supply is switched to the ON position.

## Warranty and how to use the product

Products are covered by the standard statutory warranty period. This warranty is non-transferable and financial compensation in cash is not possible. The warranty does not apply to products that have been used in a manner other than that specified in these instructions for use.

The warranty also does not cover:

- Damage resulting from improper use, neglect of care, or any other use for purposes not listed in this manual.
- Damage to appearance, damage caused by corrosion or gradual wear and tear.

Any intervention or repair by unauthorized persons results in the voiding of the product warranty.

**Seller and importer:** NajTrade s.r.o., Húskova 31, 04023 Košice, IČO: 50590502.

